

TOWER

Surface & Pendant Spotlights



Technical Features

- Body from aluminium profile painted electrostatically in selected colour or plated.
- Mounting base from aluminium, painted electrostatically in selected colour or plated.
- Special glass lens for wide light distribution.
- Pure light without IR/UV radiation.
- Operation life: 50,000 hours with efficiency > 80% of the initial luminous flux (L80B10).
- Connection for operation with Constant Current.

Upon request:

Available with highest colour rendering index (CRI)

TOWER

TOWER MINI 3

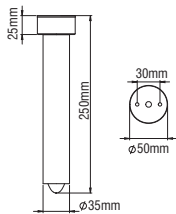

- Body from aluminium profile painted electrostatically in selected colour or plated.
- Mounting base from aluminium, painted electrostatically in selected colour or plated.
- Special glass lens for wide light distribution.
- 3W power consumption driven at 350mA.
- CRI: min. 80 / SDCM: 3
- Luminous Efficacy:
3W: 4000 K: 55 Lm/Watt
3W: 3000 K: 52 Lm/Watt

Code	Description
88083	Tower Mini 3 1x3W Warm
88084	Tower Mini 3 1x3W Neutral

TOWER MINI 3 - PENDANT

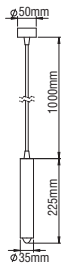

- Body from aluminium profile painted electrostatically in selected colour or plated.
- Mounting base from aluminium, painted electrostatically in selected colour or plated.
- Special glass lens for wide light distribution.
- 3W power consumption driven at 350mA.
- CRI: min. 80 / SDCM: 3
- Luminous Efficacy:
3W: 4000 K: 55 Lm/Watt
3W: 3000 K: 52 Lm/Watt

Code	Description
88085	Tower Mini 3 - Pendant 1x3W Warm
88086	Tower Mini 3 - Pendant 1x3W Neutral

TOWER

TOWER MINI 5

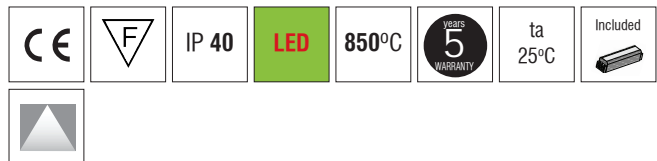
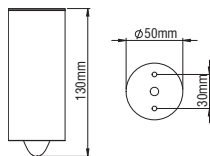

- Body from aluminium profile painted electrostatically in selected colour or plated.
- Mounting base from aluminium, painted electrostatically in selected colour or plated.
- Special glass lens for wide light distribution.
- 4W power consumption driven at 700mA.
- CRI: min. 80 / SDCM: 3
- Luminous Efficacy:
4W: 4000 K: 76 Lm/Watt
4W: 3000 K: 71 Lm/Watt

Code	Description
88087	Tower Mini 5 1x4W Warm
88088	Tower Mini 5 1x4W Neutral

TOWER

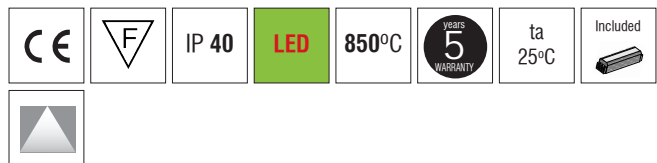
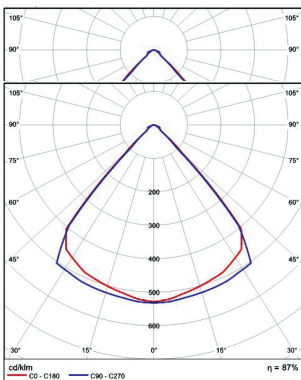
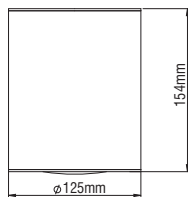

- Body from aluminium profile painted electrostatically in selected colour or plated.
- Mounting base from aluminium, painted electrostatically in selected colour or plated.
- Special glass lens for wide light distribution.
- Dimmer Phase Cut.
- CRI: min. 80 / SDCM: 3
- Luminous Efficacy:
20W: 4000 K: 1900 95 Lm/Watt
20W: 3000 K: 1800 90 Lm/Watt

Code	Description
88081	Tower 1x20W Warm
88082	Tower 1x20W Neutral

Colour Codes:

0 Colours 1 White 2 Titan 3 Black 4 Chrome 5 matt Alum.

