

NEMESIS SPOT is a miniature recessed spot, without rotation. It is ideal for smooth ambient lighting or accent lighting inside display cabinets. The last generation LED chip ensures excellent performance with maximum energy efficiency. This, in combination with an efficient thermal management, makes NEMESIS SPOT a warranty for premium lighting with LED technology.

Technical Features

- Aluminium body, painted electrostatically in selected colour.
- Reflector in glossy black colour (for standard version).
- Lens in Medium and Wide version.
- Pure light without IR/UV radiation.
- Low glare (UGR < 19).
- Efficient thermal management.
- Operation life: 50,000 hours with efficiency > 80% of the initial luminous flux (L80B10).
- Connection for operation with constant current.

Upon Request

- Available with highest colour rendering index (CRI).
- Reflector in matt white or matt silver colour.

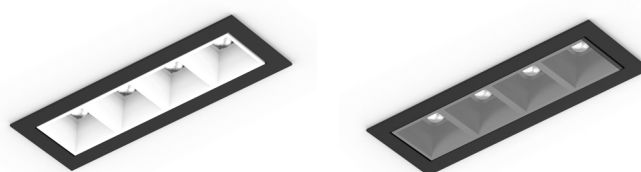

MEDIUM

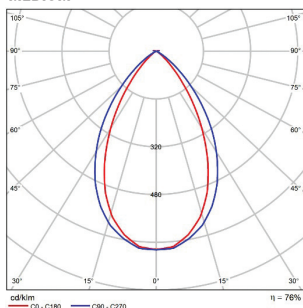

WIDE

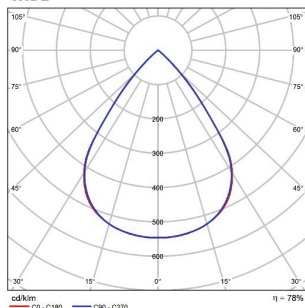

NEMESIS SPOT

NEMESIS L1



167x55mm

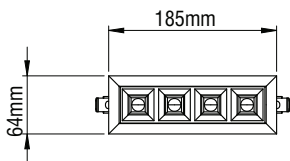
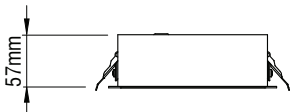

NEMESIS L2



285x55mm

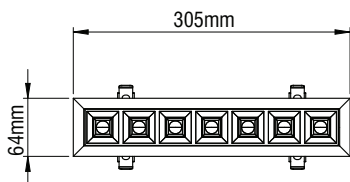
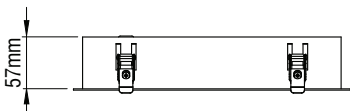

Recessed Spotlights & Downlights

CE	F	IP 40	LED	850°C	5 years WARRANTY	ta 25°C
0°	0°	▲	▲	⚡	min. 5mm	not Included

- Aluminium body, painted electrostatically.
- Lens in Medium and Wide version.
- CRI: min. 90 / SDCM: 3
- Luminous Efficacy:
4000 K: 153 Lm/Watt at 700mA
3000 K: 146 Lm/Watt at 700mA

Code	Description	Kg
85807	Nemesis L1 8W	0,300

CE	F	IP 40	LED	850°C	5 years WARRANTY	ta 25°C
0°	0°	▲	▲	⚡	min. 5mm	not Included

- Aluminium body, painted electrostatically.
- Lens in Medium and Wide version.
- CRI: min. 90 / SDCM: 3
- Luminous Efficacy:
4000 K: 153 Lm/Watt at 700mA
3000 K: 146 Lm/Watt at 700mA

Code	Description	Kg
85808	Nemesis L2 14W	0,350

NEMESIS SPOT

NEMESIS SQ1

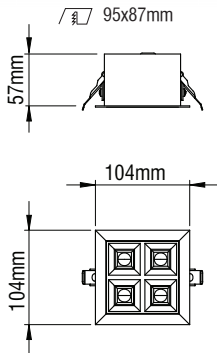
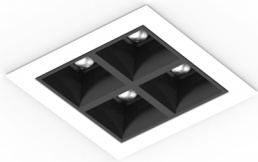

CE	F	IP 40	LED	850°C	5 years WARRANTY	ta 25°C
0°	0°				min.5mm	not Included

- Aluminium body, painted electrostatically.
- Lens in Medium and Wide version.
- CRI: min. 90 / SDCM: 3
- Luminous Efficacy:
4000 K: 153 Lm/Watt at 700mA
3000 K: 146 Lm/Watt at 700mA

Code	Description	Kg
85809	Nemesis SQ1 8W	0,300

NEMESIS SQ2

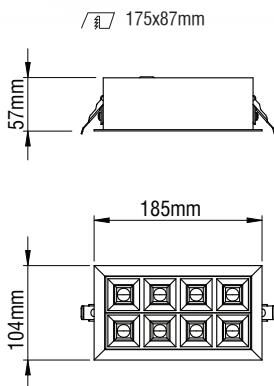

CE	F	IP 40	LED	850°C	5 years WARRANTY	ta 25°C
0°	0°				min.5mm	not Included

- Aluminium body, painted electrostatically.
- Lens in Medium and Wide version.
- CRI: min. 90 / SDCM: 3
- Luminous Efficacy:
4000 K: 153 Lm/Watt at 700mA
3000 K: 146 Lm/Watt at 700mA

Code	Description	Kg
85810	Nemesis SQ2 16W	0,500

DRIVERS DIMMER

DRIVERS	700mA 32W	700mA 38W
700mA 17W	103x67x21	146,5x43,5x30
128x37x28	1-10V / Push B.	Push B./Dalli

CODES	MODULES	800026	800040	800038
85807	NEMESIS L1 8W	1 - 2 modules	1 - 3 modules	1 - 4 modules
85808	NEMESIS L2 14W	1 module	1 - 2 modules	1 - 2 modules
85809	NEMESIS SQ1 8W	1 - 2 modules	1 - 3 modules	1 - 4 modules
85810	NEMESIS SQ2 16W	1 module	1 module	1 - 2 modules

LED COLOUR CODES:

2 Warm 3 Neutral

BEAM CODES:

02 medium 03 wide

Colour Codes:

0 Colours 1 White 2 Titan 3 Black 4 Chrome 5 matt Alum.