



Technical Features

- Steel body, electrostatically painted in white color.
- Mistlite protection glass, anti-glare with high efficient satin PMMA cover. Steel white painted frame with seal rubber and steel springs.
- Last generation high efficient LED CHIP.
- Pure light without IR/UV radiation.
- Operation life: 50,000 hours with efficiency > 80% of the initial luminous flux (L80B10).

- UGR<19:
Glare Evaluation: X=4H/ Y=8H S=0,25H, reflection factors 70/50/20.
- For DSE work stations: $\gamma \geq 65^\circ$ <3000cd/m².
- Connection for operation on 230V/50-60Hz.

Upon request:

- Connection for emergency lighting system, for one or three hours.

Recessed luminaires for panels in mineral fibre ceilings 600x600, 600x1200 with **exposed structure**.

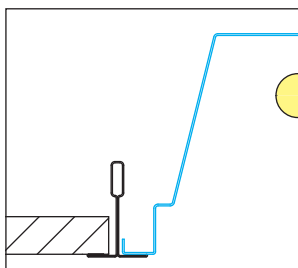

Mineral fiber panels 600x600 with exposed structure. Mounted by fitting on structure.

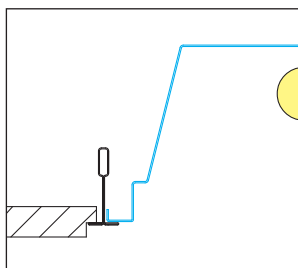

Mineral fiber panels with frame 600x600 with decoration in relief. Mounted by fitting on structure.

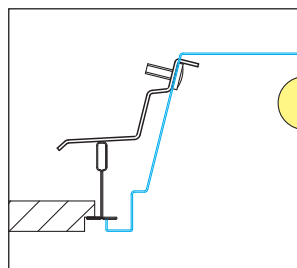

Mineral fiber panels 600x600 with decoration in relief. Mounting with exposed edge, using fixing brackets 15BS.

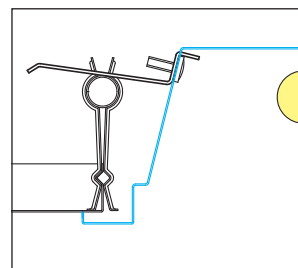

Metal panels 600x600. Mounting with exposed edge, using fixing brackets 15ZH.

LSV 320

PROFESSIONAL RECESSED LUMINAIRES

LSV 324 LED

LSV 324

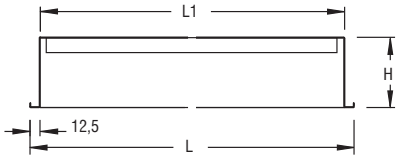
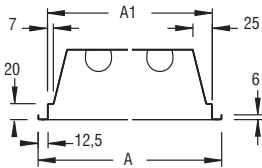
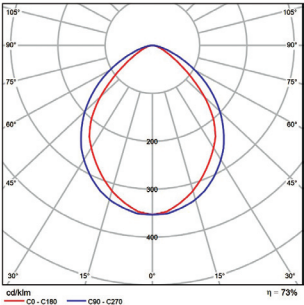

- Steel body.
- Suspension and power supply not included.
- CRI: min. 80 / SDCM: 3
- Luminous Efficacy: High Efficiency - 206 Lm/Watt 4000K
195 Lm/Watt 3000K
High Output - 201 Lm/Watt 4000K
189 Lm/Watt 3000K

Description (High Efficiency 250mA)	For panels with structure	Dimensions					Code
		A	L	H	A1	L1	
LSV 324 LED 49W Warm	600 x 600	596	596	95	573	573	383603
LSV 324 LED 49W Neutral	600 x 600	596	596	95	573	573	383613

Description (High Output 350mA)	For panels with structure	Dimensions					Code
		A	L	H	A1	L1	
LSV 324 LED 70W Warm	600 x 600	596	596	95	573	573	383623
LSV 324 LED 70W Neutral	600 x 600	596	596	95	573	573	383633

For dimmer version add letter “D” at the end of product code.

